

Swichgage® Shutdown Panel Kit

CAT-92226B
Revised 04-06
Catalog Section 30
(00-02-0080)



Model W0270

- Fits Caterpillar, Perkins and Detroit Diesel 4 and 6 Cylinder Engines
- Complete Kit Ready for Easy Installation
- Includes Wiring Harness
- Mount Either Side of Engine, or On Top
- Enclosed and Shock-Mounted
- Easily Expandable

Description

The W0270 is a compact, low profile Swichgage shutdown panel kit. It is designed to fit the following power units:

- Caterpillar 3054 and 3056
- Perkins 1004 and 1006
- Detroit Diesel 1000 Series.

A universal shock-mounted bracket allows mounting on either side of the engine, or on top, for your power unit configurations. The kit is ready for quick, easy installation with provision for installing customer supplied ignition/start key switch. All wiring is included in the panel.

This panel kit is ideal for all types of power unit applications—irrigation pumps, grain dryers, compressors, generators, etc.

Standard Features

- Engine oil pressure monitoring Swichgage instrument (20P-F)
- Coolant temperature monitoring Swichgage instrument (20T-F)
- Voltmeter (VM12/VM24)
- Closed-loop 518PH Magnetic Switch
- Emergency stop button (PB128S)
- Provision for throttle cable
- Provision for customer supplied key switch (loom is prewired —mount and plug-in)
- Provision for optional tachometer or hourmeter (loom is prewired)
- Provision for one additional Swichgage instrument such as irrigation pump discharge pressure monitoring

- All items prewired including tachometer or hourmeter
- Complete external wiring harness including wiring for pre-heat and shutdown solenoid

How to Order

Specify model number and voltage when ordering. **W0270 –**

12: 12 VDC
24: 24 VDC

Order oil line assembly separately.

Warranty

A limited warranty on materials and workmanship is given with this FW Murphy product. A copy of the warranty may be viewed or printed by going to www.fwmurphy.com/support/warranty.htm



Dimensions

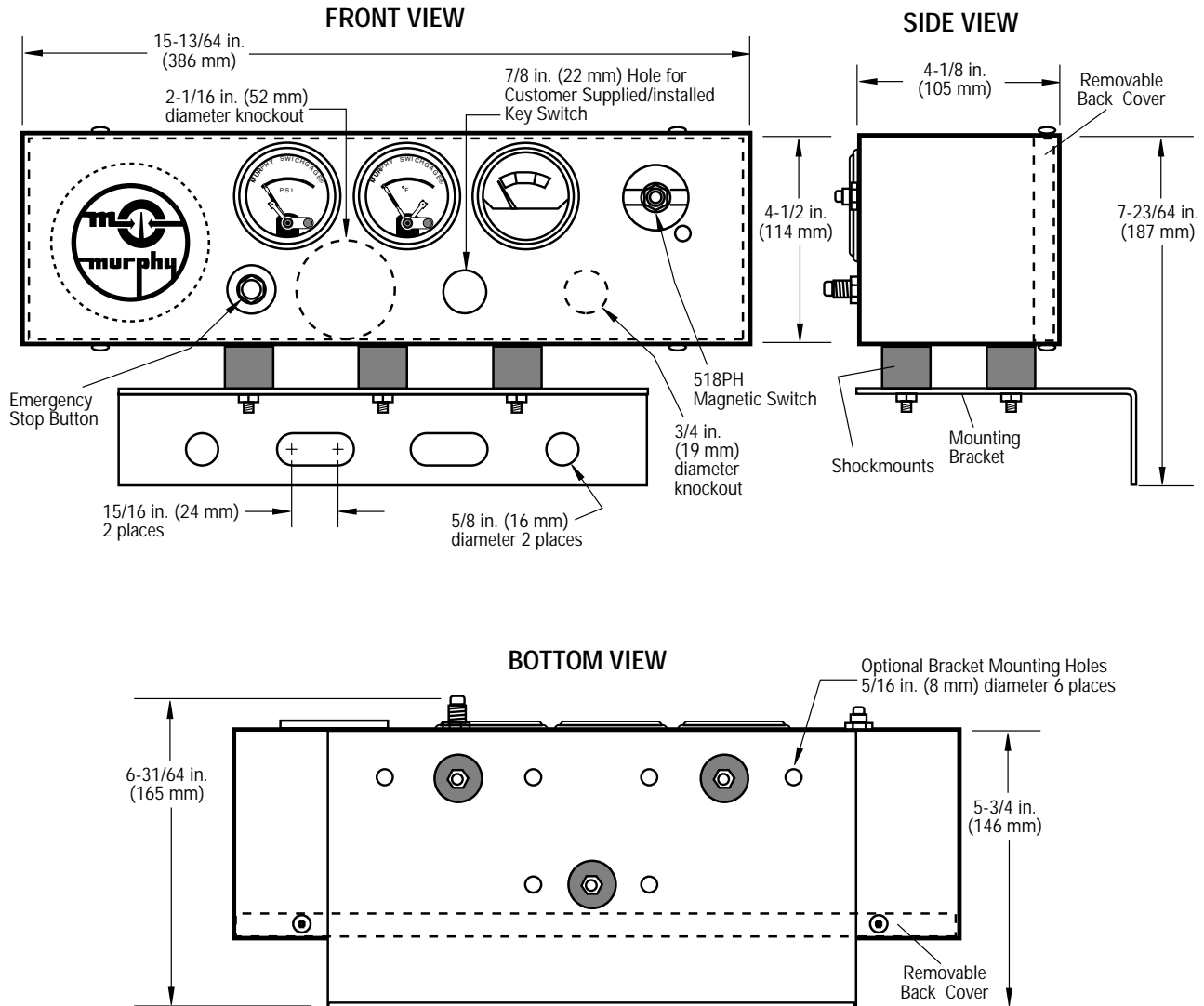

北京

信德迈科技(北京)有限公司 CNMEC Technology
 地址：北京市朝阳区安贞桥胜古中路2号金基业大厦201室
 邮编：100029
 *Tel: 010-8428 2935 | * Fax: 010-8428 8762
 *手机：139 1096 2635
 *电子邮件：sales@cnmec.biz
 主页：http://www.cnmec.com

In order to consistently bring you the highest quality, full featured products, we reserve the right to change our specifications and designs at any time. MURPHY, the Murphy logo, and Swichgag® are registered and/or common law trademarks of Murphy Industries, Inc. This document, including textual matter and illustrations, is copyright protected by Murphy Industries, Inc., with all rights reserved. (c) 2006 Murphy Industries, Inc.

In order to consistently bring you the highest quality, full featured products, we reserve the right to change our specifications and designs at any time.

Printed in U.S.A.